

# XL marlin Lighting

Prolux -Surface mounted ( XL2698 ) Installation Instruction

The user: thank you for your purchase use this product, read this instruction manual before usage

1. Model: XL2698
2. Rated Voltage: AC220-240V 50-60Hz
3. Rated Power: 25W/35W
4. IP Grade: IP65
5. Operating Temperature: -20°C~65°C

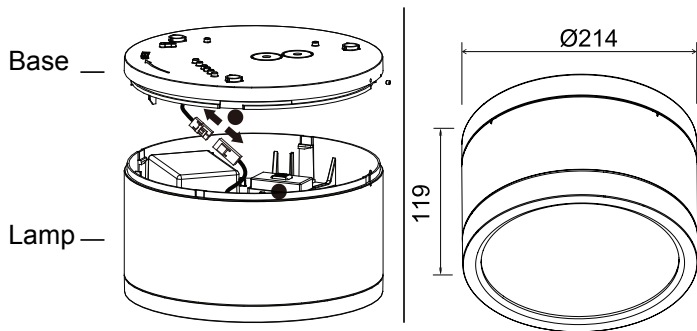

- Always disconnect the power supply before installing or performing any maintenance operations.
- Installation should be carried out by a suitably qualified person in accordance with good electrical practice and the appropriate national wiring regulations.
- These luminaires are widely used in commercial lighting, home decoration lighting, art gallery and museums.
- Only can be touched after 3 minutes later when power off, so as to avoid burns.
- Dismantling and refit are forbidden
- Installation on inflammables is forbidden.

If the external flexible cable or cord of this luminaire is damaged, it shall be exclusively replaced by the manufacturer or his service agent or a similar qualified person in order to avoid a hazard.

1. Unscrew the screw from the side of the lamp
2. Turn the base clockwise to release

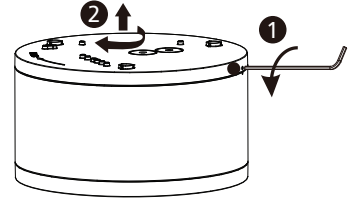

3. Disconnect the cable between the lamp and the base
4. Select preferred colour temperature

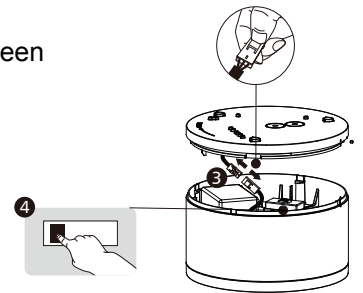

5. Fix the base in the desired location
6. Connect the power supply

L — Switched  
⊕ — Earth  
N — Neutral

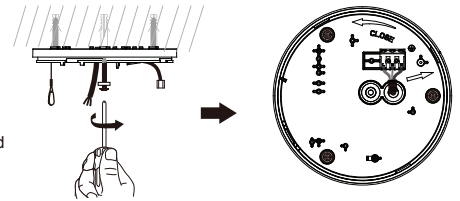

7. Connect the safety wire between the base and the lamp
8. Connect the cable wire between the base and the lamp

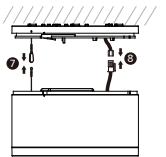

9. Turn the lamp clockwise to fix it to the base

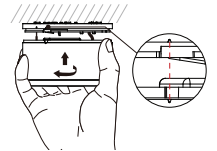

10. Return the screw and fix it tightly

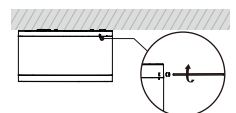

11. Connect the power supply, light up the lamp.

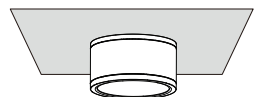

The light source of this luminaire is not replaceable; when the source reaches its end of life the whole luminaire shall be replaced

Welcome you again to buy our products