

**Model: XLCL320BL**  
**Weatherproof-Round**



**General Data**

Lamp Type	SMD2835
System Watts	24 W
Lumens	2100 lm
Lamp Life	50000 hrs
CRI	>80 Ra
Beam Angle	120°
IP Rating	IP 65
Voltage	220-240V
CCT	3000/6500K
Oper. temp.	-20 to +40
Dimension	Ø320x75

**Construction Data**

IP rating	IP 65 Outdoor
Housing	PC housing
Protection finishing	/
Glass	PC cover
Loading capacity	/
Cable Gland	IP65
Gasket	Silicone rubber gasket

**Electrical Data**

Input voltage	220-240V
Cable	/

**Accessories**

Mounted Accessory	/
Clip	/

**APPLICATIONS**

Ideal for general lighting indoors or outdoors, commercial and residential applications.

**PRODUCT DESCRIPTION**

Surface mounted or suspended mounted LED Weatherproof Injection for PC housing and PC cover, offering IP65 protection against moisture and dust.

**FIXTURE CONSTRUCTION**

PC housing and PC cover locked by screws, vandal proof.

**Dimension Drawing**

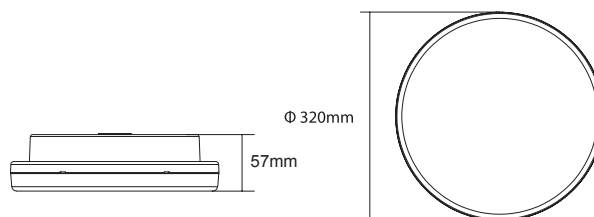

**Lamp Options**

Part Number	CCT
XLCL320BL3	3000 K
XLCL320BL65	6500 K

Light Distribution Curve [Unit: cd]

**Photometric Data**

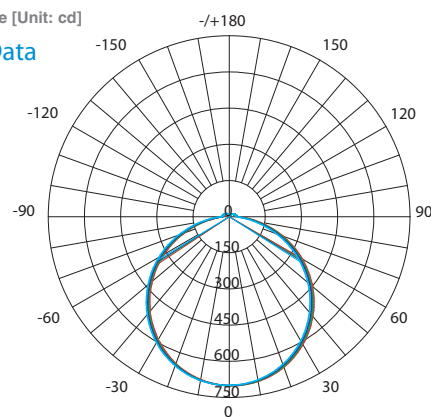

Beam angle

Height	Beam Diameter (mm)	Beam Diameter (cm)
1m	181.8, 700.61 x	321.34cm
2m	45.44, 175.21 x	642.69cm
3m	20.20, 77.851 x	964.03cm
4m	11.36, 43.791 x	1285.37cm
5m	7.270, 28.021 x	1606.72cm
6m	5.049, 19.461 x	1928.06cm
7m	3.709, 14.301 x	2249.40cm
8m	2.840, 10.951 x	2570.74cm
9m	2.244, 8.6501 x	2892.09cm
10m	1.818, 7.0061 x	3213.43cm