

# XL marlin Lighting

## Strip Lights - Neon Flex IP67 ( NF1615ST) Installation Instruction

The user: thank you for your purchase use this product, read this instruction manual before usage

1. Model: NF1615ST
2. Top & Side Bend
3. Rated Voltage: DC 24V
4. Rated Power: 5w/m-12w/m
5. IP Grade: IP67
6. Roll Length: 5M

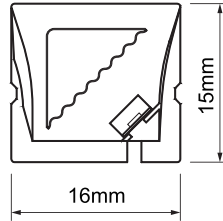

- 1- Cut the LED neon strips to your desired length using sharp scissors at the dash cutting line indicated on the LED neon strip.

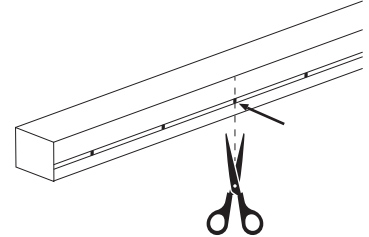

- 2- Put the mounting clips or the mounting channels on the right place and fix them with screws

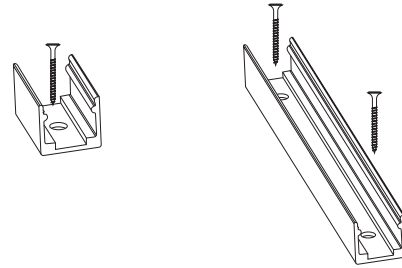

- 3- Put the parts of the strip light inside the channel / clip and make sure the shiny surface is facing up. using the palm of one hand while using the other hand to gently guide the rest of the strips.

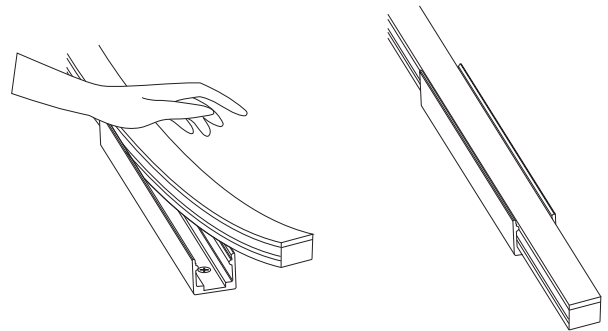

- Always disconnect the power supply before installing or performing any maintenance operations.
- Installation should be carried out by a suitably qualified person in accordance with good electrical practice and the appropriate national wiring regulations.
- These luminaires are widely used in commercial lighting, home decoration lighting, art gallery and museums.
- Only can be touched after 3 minutes later when power off, so as to avoid burns.
- Dismantling and refit are forbidden
- Installation on inflammables is forbidden.

If the external flexible cable or cord of this luminaire is damaged, it shall be exclusively replaced by the manufacturer or his service agent or a similar qualified person in order to avoid a hazard.

4. USE THE FOLLOWING DIAGRAMS TO CONNECT TO THE POWER SOURCE

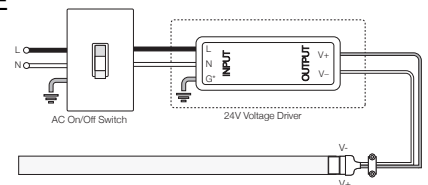

The light source of this luminaire is not replaceable; when the source reaches its end of life the whole luminaire shall be replaced

Welcome you again to buy our products