

# XL marlin Lighting

Magnetic Recessed Mini track ( XLCTMNZB ) Installation Instruction

The user: thank you for your purchase use this product, read this instruction manual before usage

1. Model: XLCTMNZB
2. Rated Voltage:DC48V
3. IP Grade: IP20
4. Dimension: (1000/2000)\*35\*26mm

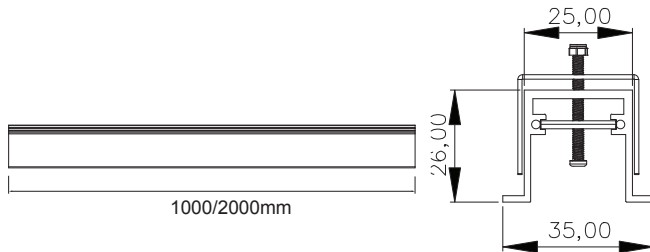

- Always disconnect the power supply before installing or performing any maintenance operations.
- Installation should be carried out by a suitably qualified person in accordance with good electrical practice and the appropriate national wiring regulations.
- These luminaires are widely used in commercial lighting, home decoration lighting, art gallery and museums.
- Only can be touched after 3 minutes later when power off, so as to avoid burns.
- Dismantling and refit are forbidden
- Installation on inflammables is forbidden.

If the external flexible cable or cord of this luminaire is damaged, it shall be exclusively replaced by the manufacturer or his service agent or a similar qualified person in order to avoid a hazard.

## 1. Cut ceiling panel

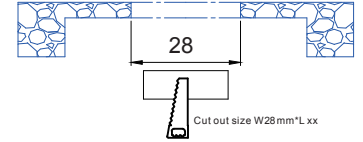

## 2. After the power is cut off, the track power line is connected to the DC 48V power supply

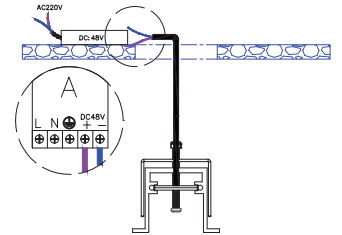

## 3. Tighten the screw to fix the track in to place

### 4-(A) After the track is fixed, the track needs to be energized and tested.

### 4-(B) The track is energized and tested normally, and then the board is sealed.

### 4-(C) Brush the gap between the ceiling on the track and make sure it does not fall into the track. And clean up all the debris in the track.

**NO FOREIGN MATTER IN THE TRACK GROOVE**

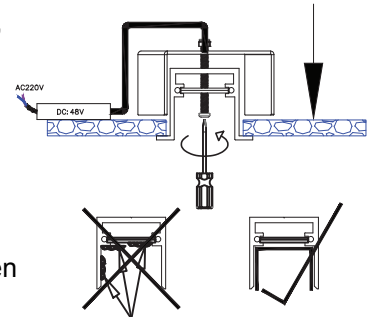

## 5. by pushing the lamp it will be fixed to the track by magnets

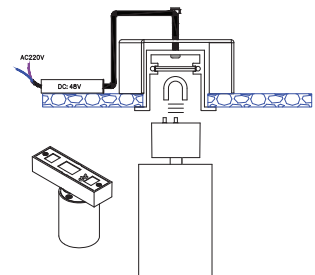

## 6. Attach your desired Magnetic track light

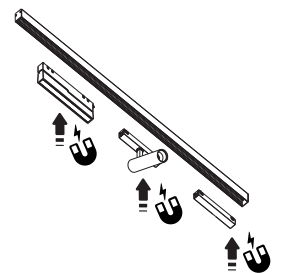

The light source of this luminaire is not replaceable; when the source reaches its end of life the whole luminaire shall be replaced

Welcome you again to buy our products

# XL marlin Lighting

## Magnetic Rimless Track Mini track ( XLCTMNWB ) Installation Instruction

The user: thank you for your purchase use this product, read this instruction manual before usage

1. Model: XLCTMNWB
2. Rated Voltage:DC48V
3. IP Grade: IP20
4. Dimension: (1000/2000)\*57\*42mm

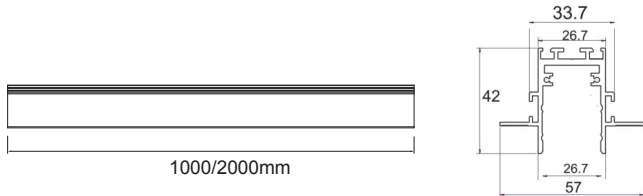

- Always disconnect the power supply before installing or performing any maintenance operations.
- Installation should be carried out by a suitably qualified person in accordance with good electrical practice and the appropriate national wiring regulations.
- These luminaires are widely used in commercial lighting, home decoration lighting, art gallery and museums.
- Only can be touched after 3 minutes later when power off, so as to avoid burns.
- Dismantling and refit are forbidden
- Installation on inflammables is forbidden.

If the external flexible cable or cord of this luminaire is damaged, it shall be exclusively replaced by the manufacturer or his service agent or a similar qualified person in order to avoid a hazard.

1. Cut ceiling panel

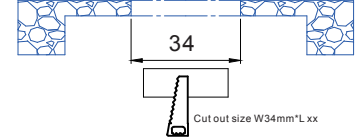

2. After the power is cut off, the track power line is connected to the DC 48V power supply

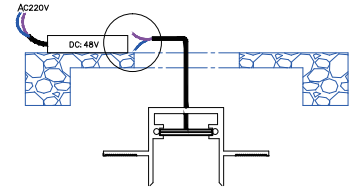

3. There are mounting holes on both sides of the track, which are fixed with screws

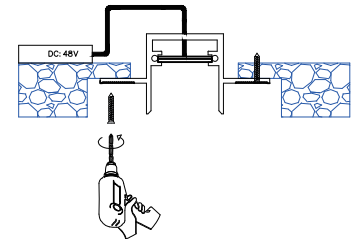

- 4-(A) After the track is fixed, the track needs to be energized and tested.

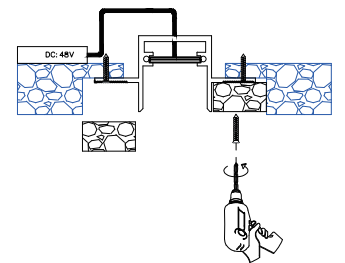

- 4-(B) The track is energized and tested normally, and then the board is sealed.

- 4-(C) Brush the gap between the ceiling on the track and make sure it does not fall into the track. And clean up all the debris in the track.

**NO FOREIGN MATTER IN THE TRACK GROOVE**

5. by pushing the lamp it will be fixed to the track by magnets

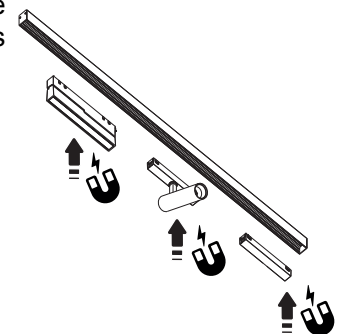

6. Attach your desired Magnetic track light

The light source of this luminaire is not replaceable; when the source reaches its end of life the whole luminaire shall be replaced

Welcome you again to buy our products

# XL marlin Lighting

Magnetic Surface mounted Mini track ( XLCTMMMZ ) Installation Instruction

The user: thank you for your purchase use this product, read this instruction manual before usage

1. Model: XLCTMMMZ
2. Rated Voltage:DC48V
3. IP Grade: IP20
4. Dimension: (1000/2000)\*25\*26mm

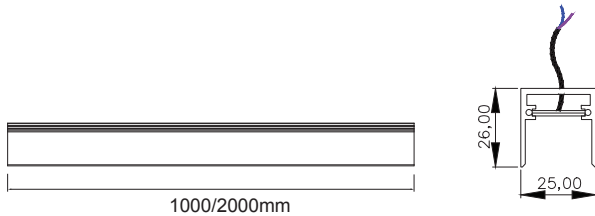

- Always disconnect the power supply before installing or performing any maintenance operations.
- Installation should be carried out by a suitably qualified person in accordance with good electrical practice and the appropriate national wiring regulations.
- These luminaires are widely used in commercial lighting, home decoration lighting, art gallery and museums.
- Only can be touched after 3 minutes later when power off, so as to avoid burns.
- Dismantling and refit are forbidden
- Installation on inflammables is forbidden.

If the external flexible cable or cord of this luminaire is damaged, it shall be exclusively replaced by the manufacturer or his service agent or a similar qualified person in order to avoid a hazard.

1. Prepare and connect power supply

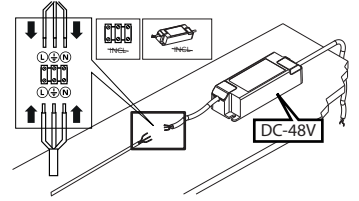

2. Fix the track to the ceiling using provided screws

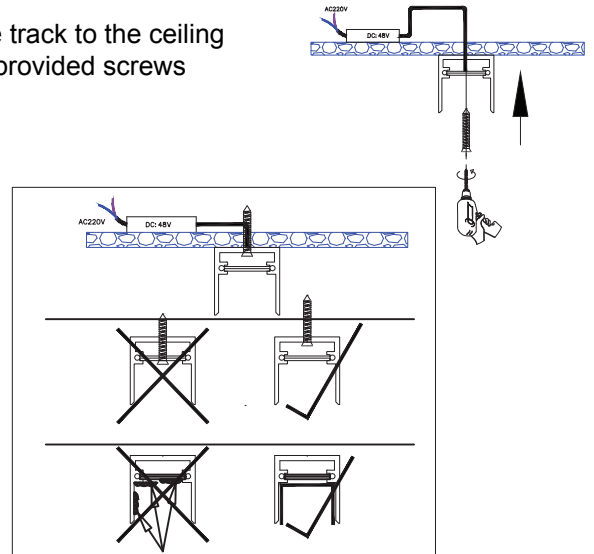

3. by pushing the lamp it will be fixed to the track by magnets

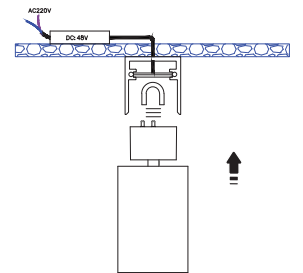

4. Attach your desired Magnetic track light

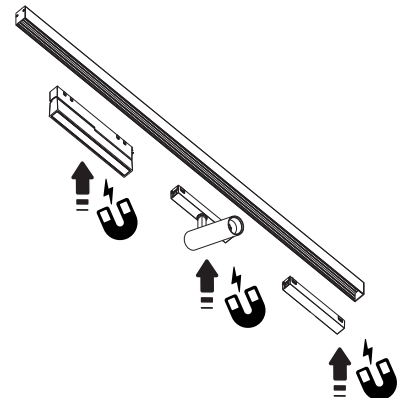

The light source of this luminaire is not replaceable; when the source reaches its end of life the whole luminaire shall be replaced

Welcome you again to buy our products