

**Model: XLCL270BL**  
**Weatherproof-Round**



**General Data**

Lamp Type	SMD2835
System Watts	20 W
Lumens	1800 lm
Lamp Life	50000 hrs
CRI	>80 Ra
Beam Angle	120°
IP Rating	IP 65
Voltage	220-240V
CCT	3000/6500K
Oper. temp.	-20 to +40
Dimension	Ø270x75

**Construction Data**

IP rating	IP 65 Outdoor
Housing	PC housing
Protection finishing	/
Glass	PC cover
Loading capacity	/
Cable Gland	IP65
Gasket	Silicone rubber gasket

**Electrical Data**

Input voltage	220-240V
Cable	/

**Accessories**

Mounted Accessory	/
Clip	/

**APPLICATIONS**

Ideal for general lighting indoors or outdoors, commercial and residential applications.

**PRODUCT DESCRIPTION**

Surface mounted or suspended mounted LED Weatherproof Injection for PC housing and PC cover, offering IP65 protection against moisture and dust.

**FIXTURE CONSTRUCTION**

PC housing and PC cover locked by screws, vandal proof.

**Dimension Drawing**

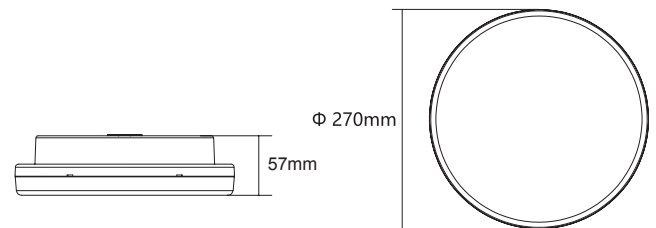

**Lamp Options**

Part Number	CCT
XLCL270BL3	3000 K
XLCL270BL65	6500 K

**Light Distribution Curve [Unit: cd]**

**Photometric Data**

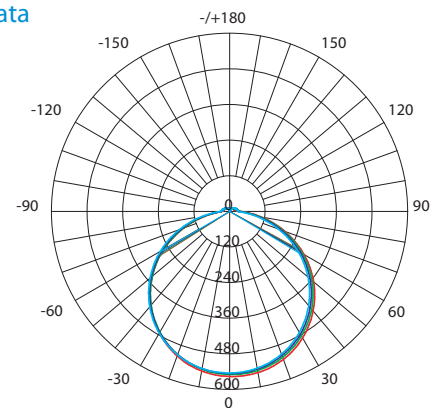

**Beam angle**

Height	Beam Diameter (cm)	Area (cm²)	Radius (cm)
1m	144.6	556.31 x	329.23cm
2m	36.14	139.11 x	658.47cm
3m	16.06	61.811 x	987.70cm
4m	9.034	34.771 x	1316.93cm
5m	5.782	22.251 x	1646.17cm
6m	4.015	15.451 x	1975.40cm
7m	2.950	11.351 x	2304.63cm
8m	2.259	8.6921 x	2633.87cm
9m	1.785	6.8681 x	2963.10cm
10m	1.446	5.5631 x	3292.33cm