

# XL marlin Lighting

Hilux Linear Lighting (XLHB200HE) installation Instruction

The user: Thank you for your purchase of this product, read this instruction manual before usage

1. Model: XLHB200HE
2. Rated Voltage: AC100~277V, 50/60Hz
3. Power: 200W
4. IP Rating: IP66
5. Working Temperature: -25 to +45°

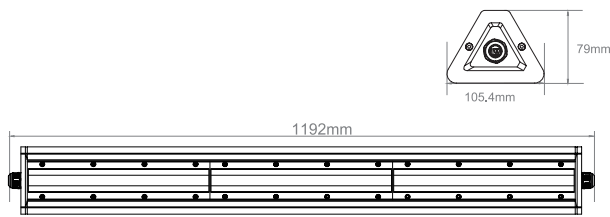

- Always disconnect the power supply before installing or performing any maintenance operations.
- Installation should be carried out by a suitably qualified person in accordance with good electrical practice and the appropriate national wiring regulations.
- These luminaires are widely used in Warehouses , workshop, highway toll station, gas station, supermarket, exhibition hall, gymnasium, and other industrial and commercial lighting purposes
- Only can be touched after 3 minutes later when power off, so as to avoid burns.
- Dismantling and refit are forbidden
- Installation on inflammables is forbidden.

If the external flexible cable or cord of this luminaire is damaged, it shall be exclusively replaced by the manufacturer or his service agent or a similar qualified person in order to avoid a hazard.

## A-BRACKET MOUNT

1. Fix the installation components to the ceiling

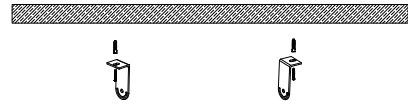

2. Connect the bracket and mounting parts with a hex wrench for installation

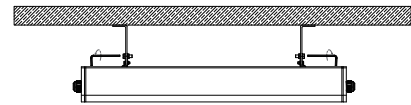

## B-PENDANT MOUNT

1. Secure the hanging cable to the pre installed hook

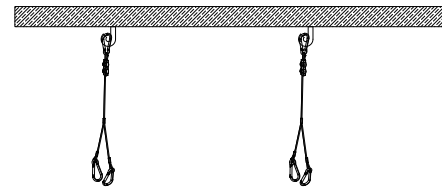

2. Install the end cap and complete the lamp installation

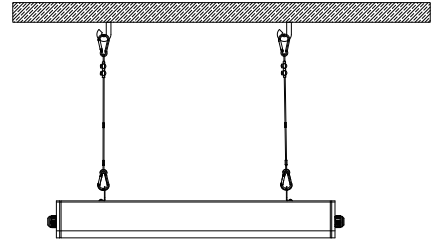

## C-WIRING

1. Use a hex wrench to remove the end cap

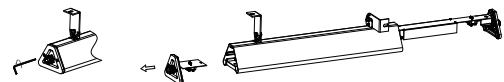

2. UThread the wire through the waterproof joint and connect the wire according to the terminal identification

3. Install the end cap and complete the lamp installation

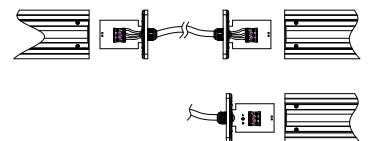

The light source of this luminaire is not replaceable; when the source reaches its end of life the whole luminaire shall be replaced

Welcome you again to buy our products